

## Description

The next generation in compressor heat technology. The sleek aluminium design offers improved performance with installer friendly features.

## Technical specification

Material	High temperature silicone rubber heat cable. Extremely efficient aluminium casting with a unique profile. Stainless steel adjustable toggle clamp and band. Maximum operating temperature 150°C.
Dimension	Shapes and sizes available to fit standard compressors. Custom shape and sizes available to fit specific compressor.
Connection	Tab terminals
Voltage	600 V maximum 277 V maximum with thermostat control
Safety	U.L., C.S.A. and CE listed

## Standard range on stock

Diameter	Dia. Min-Max	Power	Article number
139 mm	124-178 mm	40 W	3840 028 001
168 mm	165-220 mm	40 W	3840 028 010
186 mm	172-226 mm	70 W	3840 028 017
233 mm	227-281 mm	90 W	3840 028 024
273 mm	248-302 mm	70 W	3840 028 027
273 mm	275-330 mm	120 W	3840 028 035
334 mm	319-373 mm	140 W	3840 028 040

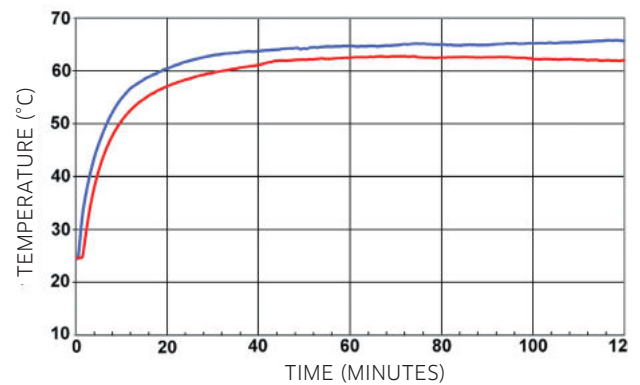
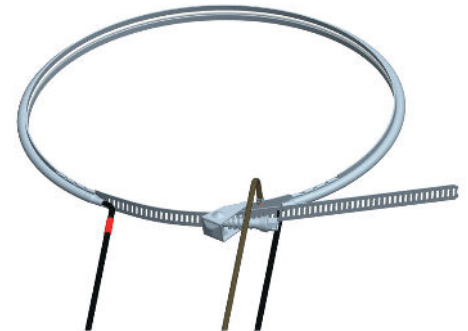

Migration tests has proven that our heaters (Blue Line) could reach the desired temperature faster than current heaters (Red Line). Our heaters also require 5-7% less wattage to maintain the same amount of heat in the compressor, which would reduce the energy consumption.

## Crankcase heater

### Benefits

- Easy to install
- Quick adjustment
- High efficiency profile
- Quick temperature rise
- Can be customized

### FIELDS OF APPLICATION

- Compressors



High Efficiency Profile

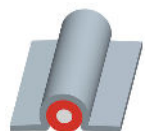

Heat Cable Positioning



Toggle Clasp