

Silver-Series 2 Removable Cloth Insulators

Energy-efficient, modular insulator system for your pipes and components



**Removable, Reusable, and Configurable
for Diverse Systems.**

BriskHeat's Silver-Series 2 Insulators are crafted with the ruggedness for a prolonged service life, these insulators are not just robust but also lightweight, making installation and handling a breeze. These insulators are fire-retardant, asbestos-free, and are easily removable and reusable, adapting to a vast array of pipe and tank systems. With thermally efficient fiberglass insulation available in both standard and custom thicknesses, and a high-temperature-rated PTFE exterior, these insulators are compatible with heating cables, tapes, and various insulating applications.

Quality Construction

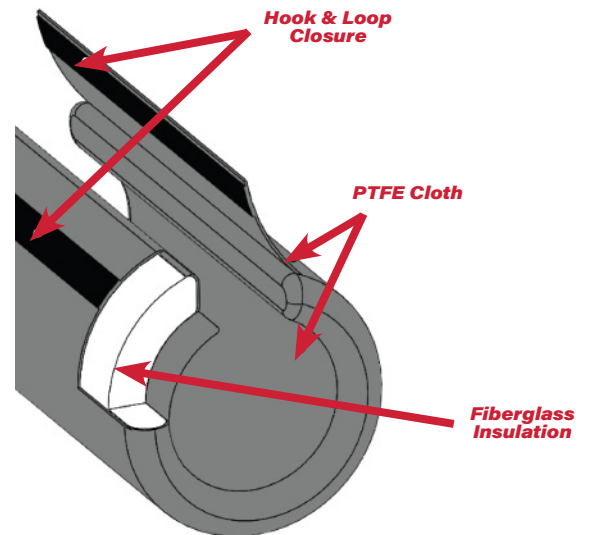

Features & Benefits

- Moisture and chemical-resistant with an IP54 rating.
- Removable, reusable, and configurable for diverse systems.
- PTFE exterior rated at 500°F, with higher ratings available.
- Thermally-efficient fiberglass insulation – 1 in (25 mm, standard) or 2 in (51 mm, custom) thickness available.



**Moisture
& Chemical
Resistant**

Explore BriskHeat's Custom Design Options

Call today and let's talk custom design options, featuring a variety of cloth materials and max exposure temperatures up to 1100°F (593°C)

Ordering Information

Tees

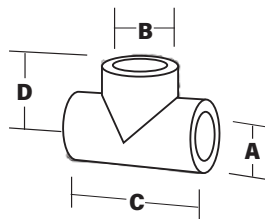

A ID of Insulator in (mm)	B ID of Insulator in (mm)	C Length in (mm)	D Height- Center-line to top in (mm)	Part No.
2.27 (58)	2.27 (58)	8.00 (203)	5.00 (127)	SSIT10-2V
2.93 (74)	2.93 (74)	9.00 (229)	5.70 (145)	SSIT15-2V
3.46 (88)	3.46 (88)	9.75 (248)	6.10 (155)	SSIT20-2V
4.09 (104)	4.09 (104)	11.00 (279)	6.80 (173)	SSIT25-2V
4.78 (121)	4.78 (121)	12.00 (305)	7.30 (185)	SSIT30-2V
5.90 (150)	5.90 (150)	14.50 (368)	8.30 (211)	SSIT40-2V

2-Way Ball Valve

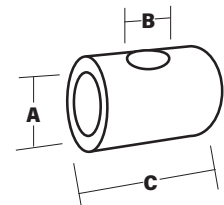

A ID of Insulator in (mm)	B Opening ID in (mm)	C Length in (mm)	Part No.
4.75 (121)	3.25 (83)	8.00 (203)	SSIVB102-2V
5.50 (140)	3.38 (86)	11.00 (279)	SSIVB152-2V
6.50 (165)	3.50 (89)	11.50 (292)	SSIVB202-2V
7.50 (191)	4.50 (114)	12.50 (318)	SSIVB252-2V
8.00 (203)	4.50 (114)	13.00 (330)	SSIVB302-2V
9.50 (241)	4.75 (121)	14.00 (356)	SSIVB402-2V

Ordering Information

Flanges

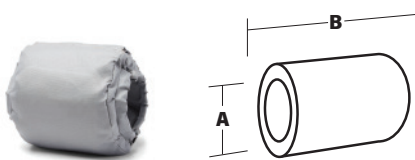

A ID of Insulator in (mm)	B Length in (mm)	Part No.
4.75 (121)	8.00 (203)	SSIF10-2V
5.50 (140)	8.00 (203)	SSIF15-2V
6.50 (165)	8.00 (203)	SSIF20-2V
7.50 (191)	8.00 (203)	SSIF25-2V
8.00 (203)	8.00 (203)	SSIF30-2V
9.50 (241)	8.00 (203)	SSIF40-2V

Straight Sections (Cut-to-Length)

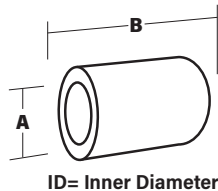

ID= Inner Diameter

A ID of Insulator in (mm)	B Length in (mm)	Part No.
1.82 (46)	90 (2286)	SSIP10CTL-2V
2.40 (61)	90 (2286)	SSIP15CTL-2V
2.88 (73)	90 (2286)	SSIP20CTL-2V
4.00 (102)	90 (2286)	SSIP30CTL-2V
5.00 (127)	90 (2286)	SSIP40CTL-2V

Total usable length for each straight insulator is 90 in (2286 mm) - can be cut-to-length in the field in 6 in (152 mm) and 12 in (305 mm) increments. Cut area 0.75 in (19 mm) wide.

90° Elbows

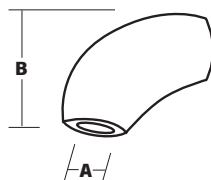
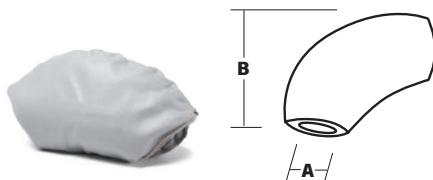

A ID of Insulator in (mm)	B Height in (mm)	Part No.
2.27 (58)	5 (127)	SSI9010-2V
2.93 (74)	6 (152)	SSI9015-2V
3.46 (88)	7 (178)	SSI9020-2V
4.78 (121)	8.5 (216)	SSI9030-2V
5.90 (150)	11 (279)	SSI9040-2V

Seam Covers

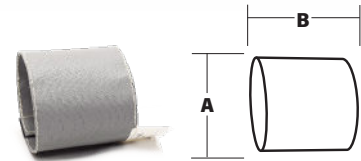

A ID of Insulator in (mm)	B Length in (mm)	Part No.
3.88 (99)	3.50 (89)	SSIC10V-2V
4.46 (113)	3.50 (89)	SSIC15V-2V
4.94 (125)	3.50 (89)	SSIC20V-2V
6.06 (154)	3.50 (89)	SSIC30V-2V
7.06 (179)	3.50 (89)	SSIC40V-2V

*Seam covers are uninsulated sleeves which should be used over 2 adjoining straight sections to reduce heat loss.

Straight Sections (Precut Lengths)

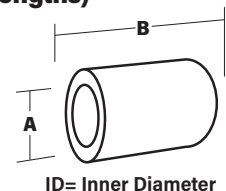

ID= Inner Diameter

Straight sections in ready-to-use lengths of 6,12, 24, 36, and 48 in (152, 305, 610, 914, and 1219 mm)

A ID of Insulator in (mm)	B Length in (mm)	Part No.
1.82 (46)	6 (152)	SSIP1006-2V
	12 (305)	SSIP1012-2V
	24 (610)	SSIP1024-2V
	36 (914)	SSIP1036-2V
	48 (1219)	SSIP1048-2V
2.40 (61)	6 (152)	SSIP1506-2V
	12 (305)	SSIP1512-2V
	24 (610)	SSIP1524-2V
	36 (914)	SSIP1536-2V
	48 (1219)	SSIP1548-2V
2.88 (73)	6 (152)	SSIP2006-2V
	12 (305)	SSIP2012-2V
	24 (610)	SSIP2024-2V
	36 (914)	SSIP2036-2V
	48 (1219)	SSIP2048-2V
4.00 (102)	6 (152)	SSIP3006-2V
	12 (305)	SSIP3012-2V
	24 (610)	SSIP3024-2V
	36 (914)	SSIP3036-2V
	48 (1219)	SSIP3048-2V
5.00 (127)	6 (152)	SSIP4006-2V
	12 (305)	SSIP4012-2V
	24 (610)	SSIP4024-2V
	36 (914)	SSIP4036-2V
	48 (1219)	SSIP4048-2V



BriskHeat Account Executives are a resource for corporate partners, local distributors, manufacturers' representatives, and end users. With distributors and reps located throughout North and South America, Asia, Europe, and Australia, local support is available to provide the right solution to your heating needs.



**Contact us for application
assistance and quote.**

4800 Hilton Corporate Drive
Columbus, OH 43232

614.294.3376 | 800.848.7673

BriskHeat.com

bhtsales1@briskheat.com